

Shropshire Council
Bridleway 27A (part) Eaton-under-Heywood
Road Traffic Regulation Act 1984 - Section 14

Temporary Prohibition of Use of Bridleway 27A (part), Eaton-under-Heywood

Shropshire Council (hereinafter referred to as "the Council") being the highway authority for the length of bridleway specified in the Schedule to this Order, is satisfied that traffic in the said length of bridleway should be regulated by reason of works to be executed on or near the said length of bridleway.

The Council, in exercise of its powers under Section 14 of the Road Traffic Regulation Act 1984 and of all other powers enabling it in that behalf, hereby makes the following order:

1. The use of the bridleway described in the Schedule to this order is hereby prohibited.
2. Nothing in Article 1 of this order shall apply so as to prevent any person from proceeding in the length of bridleway specified in that Article if that person is carrying out work in connection with the maintenance, improvement or reconstruction of that said length of bridleway.
3. This Order shall come into operation on 15th April 2025 for a period of 6 months or until the works are completed, whichever is soonest, and may be cited as The Shropshire Council (Temporary Prohibition of Use of Bridleway 27A (part), Eaton-under-Heywood) Order 2025.

THE COMMON SEAL OF)
SHROPSHIRE COUNCIL)
was affixed hereto the)
)

in the presence of:

Tim Collard

Tim Collard
Assistant Director, Legal and Governance
(Monitoring Officer)

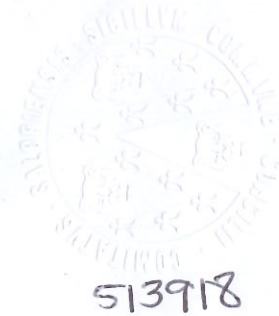

SCHEDULE

Bridleway 27A (part) runs from its junction with Munslow Footpath 30B & Bridleway UN8 at grid reference SO 5072 9014, in a general north, then north-east direction to its junction with Eaton-under-Heywood Footpath 27C and the continuation of Bridleway 27A at grid reference SO 5085 9028.

There is no alternative route available.

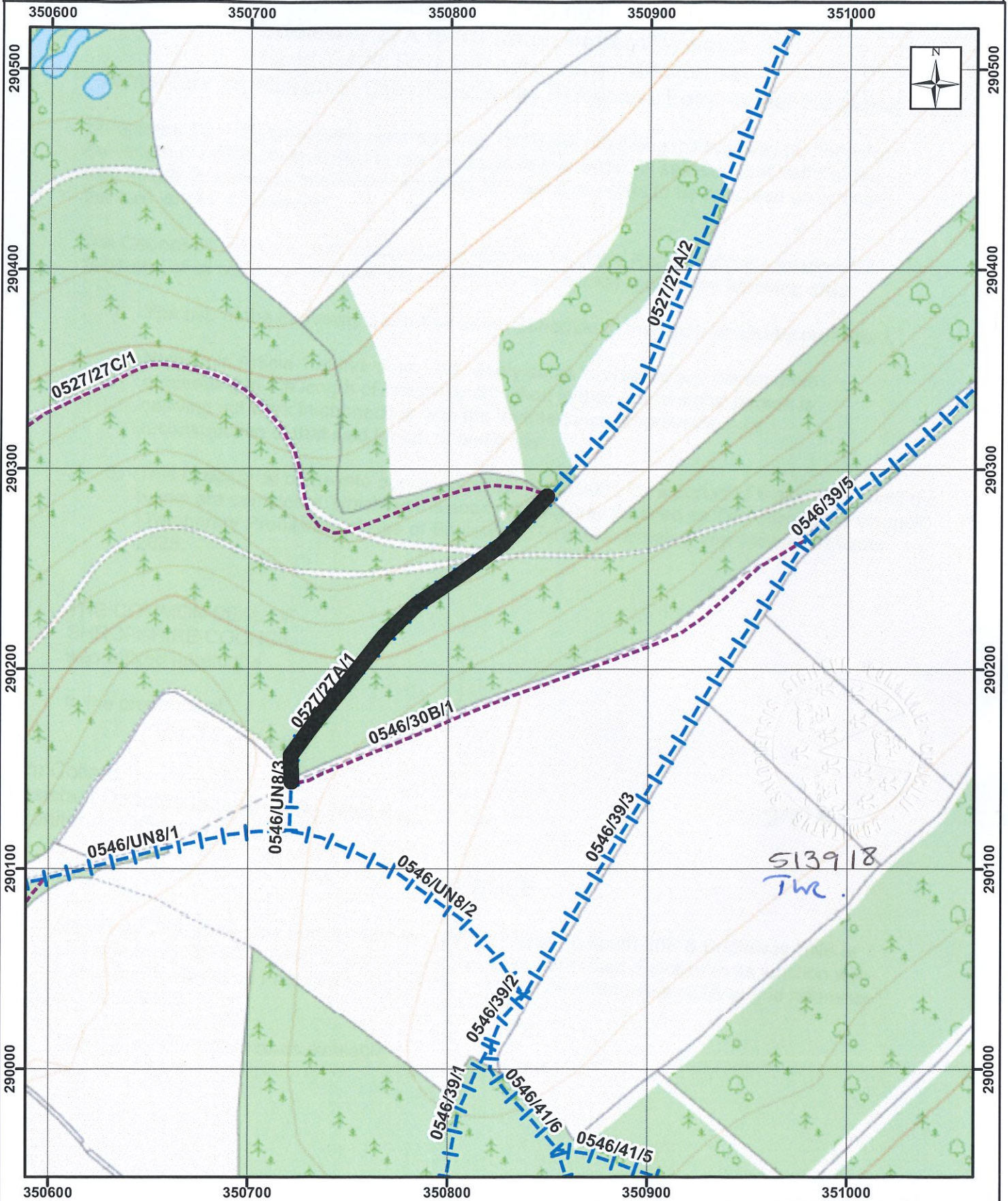

513918
TW

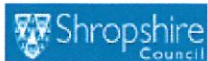

The Guildhall, Frankwell Quay,
Shrewsbury, SY3 8HQ

Key
Public Bridleway Temporarily Closed

© Crown copyright (2025)
Ordnance Survey AC0000808715
You are not permitted to copy, sub-licence, distribute
or sell any of this data to third parties in any form.

Scale: 1:2,500